

INSTALLATION INSTRUCTIONS

WIDESIDER BRK

Chevrolet/GMC 1500 Crew Cab

394015

Parts list				
item	Qty.	Part No.	Description	Torque
1	8	6840470AA	Bracket	
2	2	396801AA	Small U Bracket	
3	2	397872AA	Large U Bracket	
4	18		M8 x 25mm Hex bolt	18 Lb Ft
5	18		5/16" Flat washer Zinc P.	
6	18		5/16" Lock washer Zinc P.	
7	12		5/16"x1" Hex. Bolt Black P.	18 Lb Ft
8	12		5/16" Flat washer Black P.	
9	12		5/16" Lock washer Black P.	

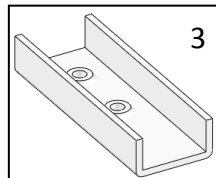
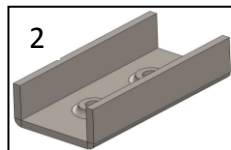
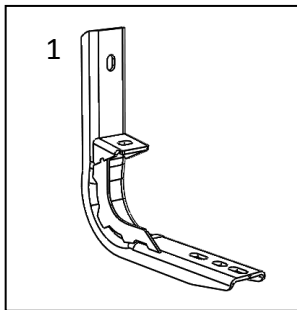

Required tools:

- A. Ratchet
- B. ½" & 13mm Socket
- C. ½" & 13mm Wrench
- D. Ratchet extension

Before beginning the installations read all instructions carefully and verify that all the hardware is accounted for. If there are any listed part missing please notify your distributor immediately. To maintain and care this product keep it clean and do not use abrasive cleaners or polish waxes. We recommend using only non-abrasive automotive wax such as pure carnauba to avoid scratches and rust.

The approximated installation time is 30 min.

1. Begin the installation on the passenger side. Locate the (4) mounting locations at the front, center and rear of the cab and the threaded studs on the inner rocker panel. Remove the plastic plugs covering the threaded holes in the body panel (FIGURE 1 & 2).

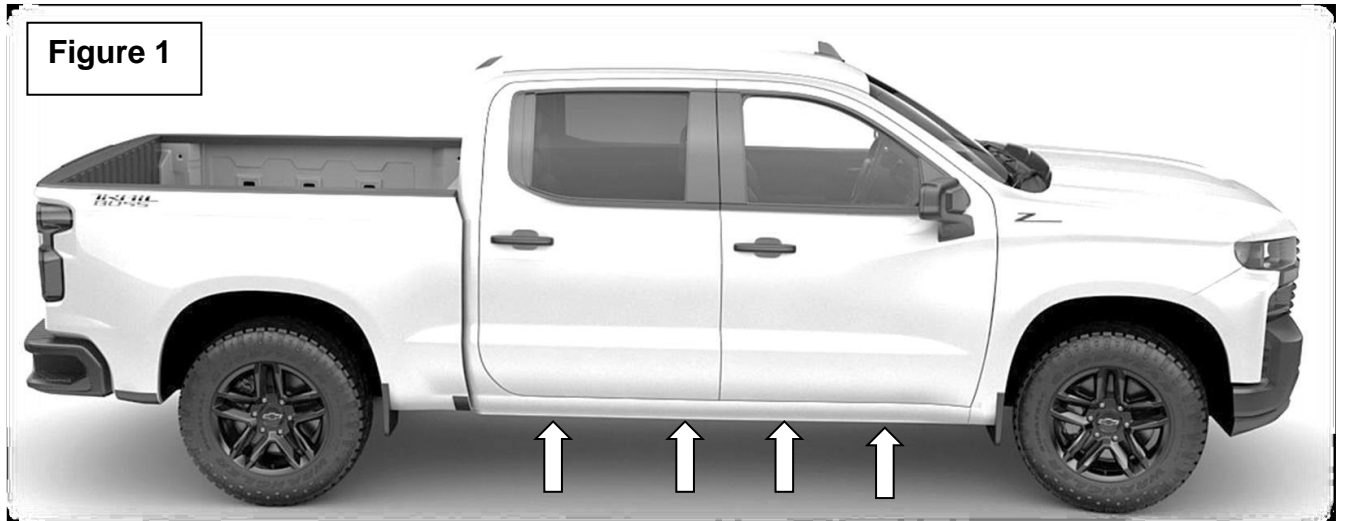
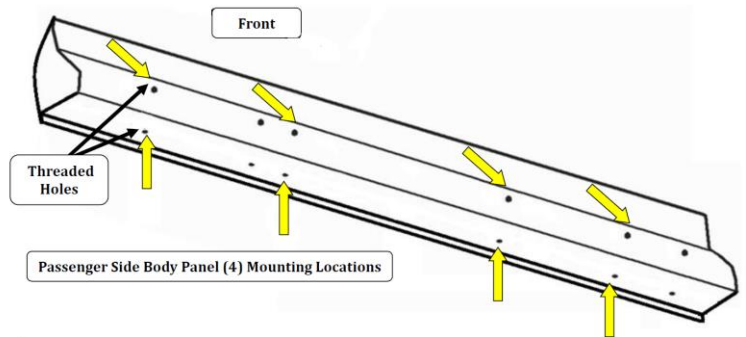
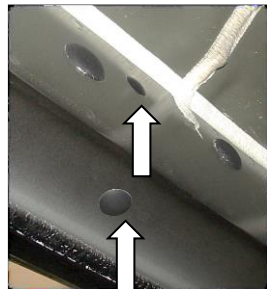

Figure 2



2. Install one of the brackets by positioning the bracket and attach to the rocker panel using (2) M8 x 25mm hex bolts, (2) 5/16" flat washers, (2) 5/16" lock washers. Leave the nuts loose for final adjustment, (FIGURE 3).

3. Repeat step 1 and 2 to install mounting brackets at the center and rear of the vehicle.

Figure 3

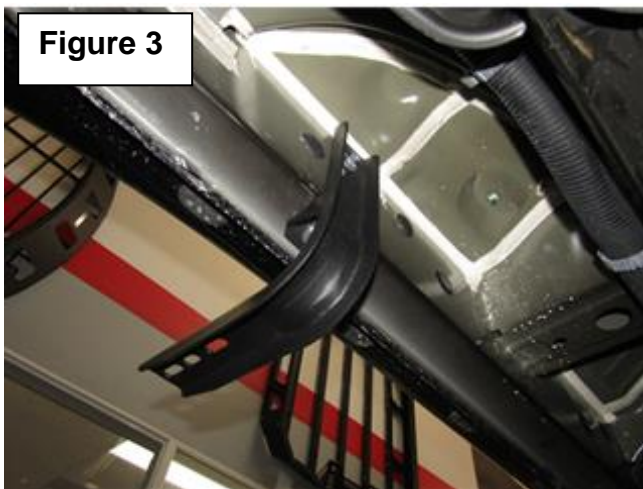

4. If installing 5" XL Widesider Composite side steps, install (6) 5/16" square head bolts (included with side steps) in the aluminum rail on the underside of the side step. Place the side step on top of the mounting brackets so the threads of the square head bolts align and extend through the holes in the brackets. Secure the side step to each bracket using the square head bolts, (2) 5/16" flat washers, (2) 5/16" lock washers and (2) 5/16" hex nuts, (FIGURE 4). Align the side step with the vehicle then tighten all side step and mounting bracket nuts and bolts.

Figure 4



Figure 5



5. If installing Fusion or Platinum widesider (FIGURE 5) place the side step on top of the mounting brackets and position the U-brackets (included with the side steps) inside the open channel in the bottom of the side step. Align the threaded holes in the U-brackets with the holes in the mounting brackets and secure the side step to each bracket using the U-bracket, (2) 5/16" x 1" hex bolts, (2) 5/16" lock washers and (2) 5/16" flat washers. Align the side step with the vehicle then tighten all side step and mounting bracket nuts and bolts.
6. Repeat steps to install the driver side brackets and side step. Remember to check and retighten the nuts and bolts every six months.